

# TPE 2012

Tobacco Plus Expo International

It's All About Business

Las Vegas Convention Center • February 1 - 2, 2012



## TPE 2012 Floor Plan

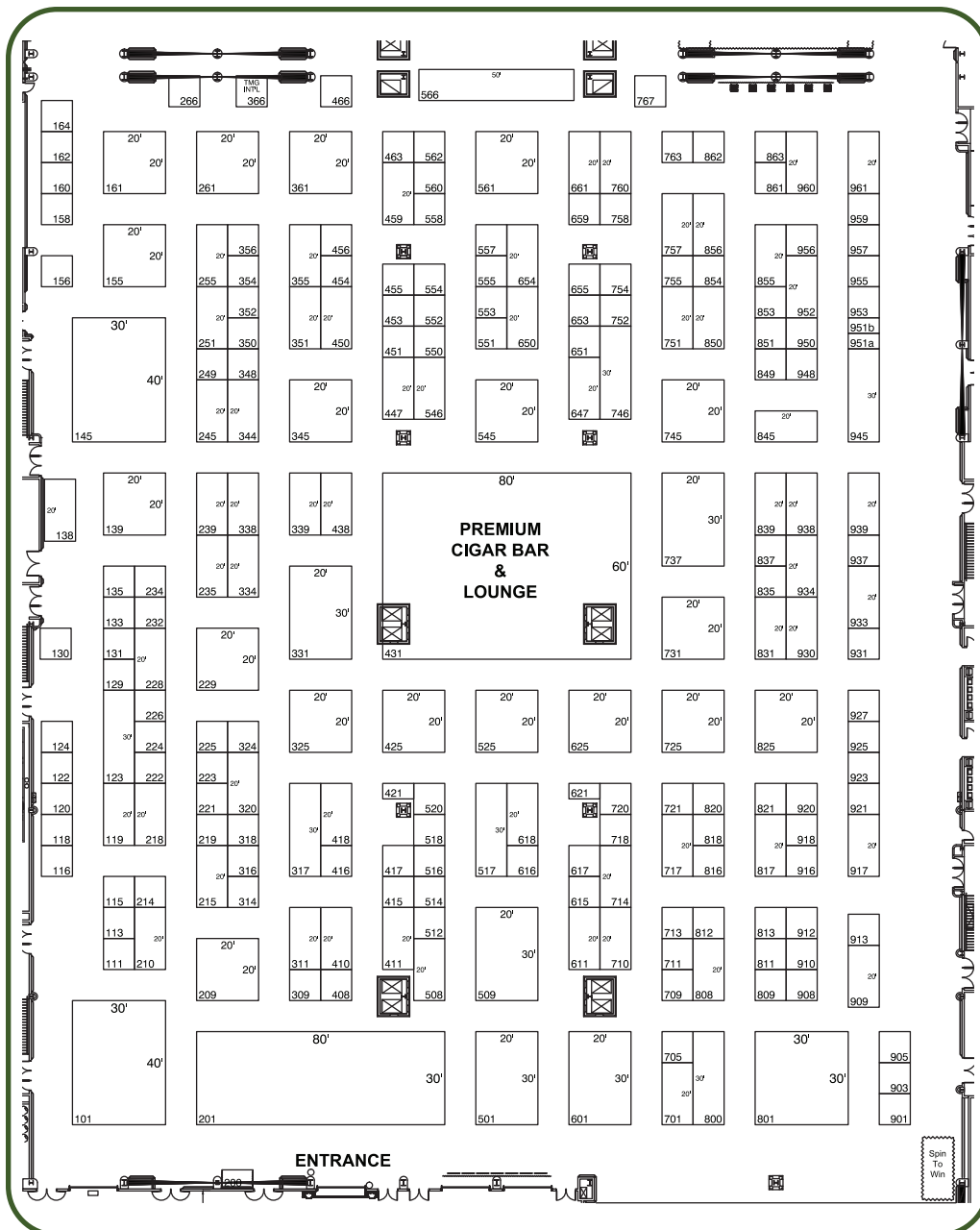

### Please Note That Your Booth Price Includes:

Each linear booth will include 8 ft high back drape, 3 ft high side drape, an ashtray, a wastebasket and a 7" x 44" Company ID Sign. Your ID sign will be the same as what is shown on your contract. Exhibitors are responsible for carpeting and furnishing their individual booths. Floor covering in your booth is mandatory. The booth identification sign is for identification only and should be replaced with a professional sign that is part of your booth.

Island Booth space includes ashtrays and wastebaskets. If you require a back drape, it can be ordered from the General Contractor, Hargrove Inc.

**Get a Prime Location...  
Contact Marilene Rivera  
at (888) 737-3976  
or by email at  
marilene@reuterexpo.com.**

REV. 1/27/12

For the latest info on TPE 2012, visit: [www.tobaccoplusexpo.com](http://www.tobaccoplusexpo.com)